

**Kreissägemotoren - Kompaktbauweise**      **Sawmotors - compact design**

Type	Leistung Power		Bauhöhe - Welle Ø Size - Shaft Ø	Drehzahl Speed	Gewicht Weight
	[kW]	[PS] [HP]	[mm]	[Upm] [rpm]	[kg]
	H71 a2SE	1,5	2	71-30	2860
H80S b2SE	3	4	80-30	2890	24,0
H80M 2SE	4	5,5	80-30	2885	28,0
H90S 2SE	5,5	7,5	90-35	2880	40,0
H90L 2SE	7,5	10	90-35	2885	46,0
H100S 2SE	9,2	12,5	100-50	2880	60,0
H80S b4SE	2,2	3	80-30	1420	24,5
H80L 4SE	3	4	80-30	1400	26,3
H90S 4SE	4	5,5	90-35	1430	37,5
H90L 4SE	5,5	7,5	90-35	1435	45,0
H100S 4SE	7,5	10	100-50	1400	60,0

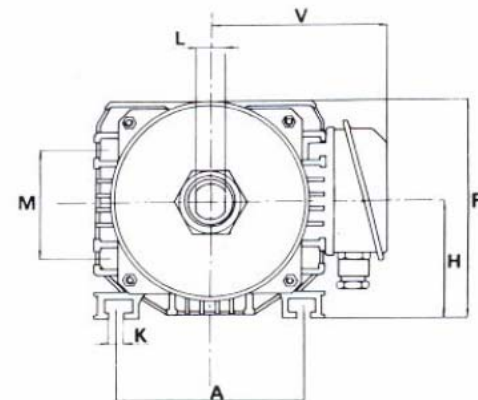
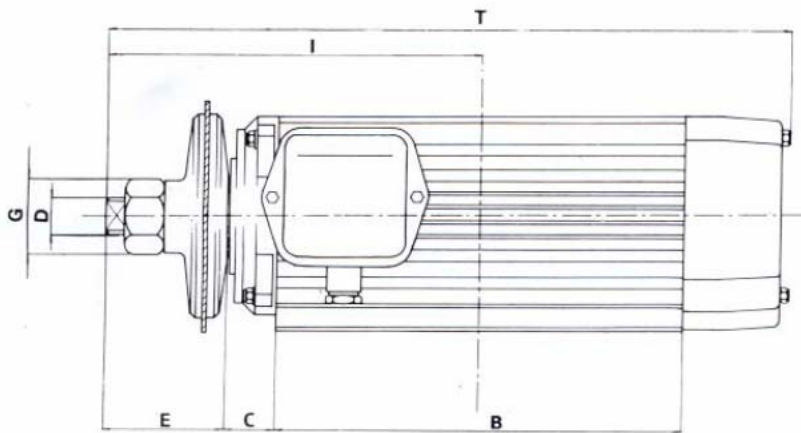

Baugr Frame Size	A	B	C	E	H	k	F	V	I	T	L	D	G	M
H71	112	240	30	78	71	9,0	130	111	224	418	20	30	50	70
H80S	125	240	30	78	80	10,3	149	121	228	422	20	30	50	74
H80M	125	280	30	78	80	10,3	149	121	248	462	20	30	50	74
H80L	125	320	30	78	80	10,3	149	121	268	502	20	30	50	74
H90S	140	330	30	78	90	10,3	165	130	274	535	25	35	60	84
H90L	140	380	30	78	90	10,3	165	130	314	605	25	35	60	84
H100S	160	330	42	113	100	14,0	189	160	320	575	30	50	70	84
H100L	160	380	42	113	100	14,0	189	160	345	625	30	50	70	84